

PARAMETERS	SYMBOL	MINIMUM	MAXIMUM
Width across flat	s	53.80	55.00
Width across corner	e	60.79	-
Head thickness	K	22.08	22.92
Shank diameter	ds	35.38	36.00
Major diameter	D	35.46	35.94
Pitch diameter	D1	33.15	33.25
Minor diameter	D2		31.61
Shank length	ls	22.00	-
Total Shank length	lg	-	42.00
Threading length	(b)	78.00	79.00
Total length	l	118.25	121.75
da	da	-	39.40
dw	dw	51.11	-
Radius of fillet	r	1.00	-
c	c	0.20	0.80
Chamfer	b	0.00	8.00
Pitch	P	4.00	

Note :

- $\beta = 15^\circ$ to 30°
- Point shall be chamfered on the threads $\leq M4$ may be as-rolled (sheared end) in accordance with ISO 4753.
- Incomplete thread $u \leq 2P$.
- Reference datum for dw.
- Maximum underhead fillet.

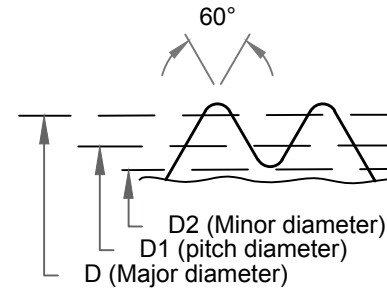
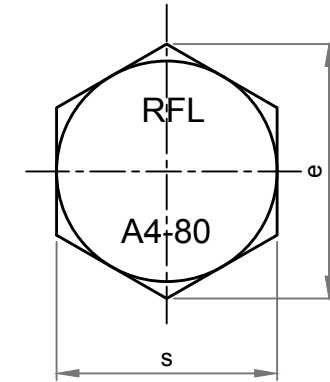
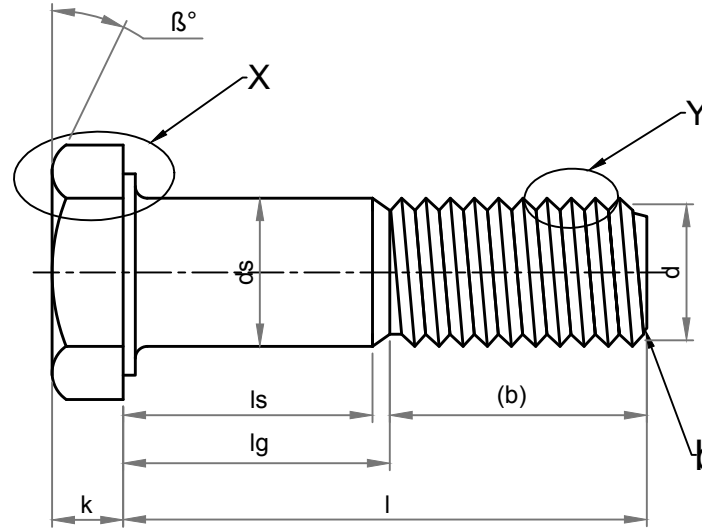

'Y' Enlarge View

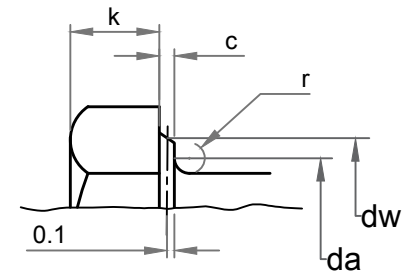

'X' Enlarge View

Dimension as per	ISO 4014
Chemical & Mechanical properties as per	ISO 3506-1
Grade	A4-80
Threading as per	ISO 965
Weight	1.320 kg/piece

DRAWING NUMBER KE-BASE-1100-00095-4014-3506.1-A4-80-36x120			SIZE M36x120	TITLE HEX BOLT			
AMENDMENT ALL DIMENSION IN MM			DATE 05.06.2020	PROJECTION 	DRAWN BY PANKAJ KUMAR (ASST. QC MANAGER)	CHECKED BY SANTOSH KUMAR (PLANT HEAD-GM)	APPROVED BY KAPIL AGGARWAL CEO-MD
DETAILS	REVISION	DATE	APPROVED	ROLL FAST STAINLESS STEEL BOLTS HIGH TENSILE BOLTS PRECISION TURNED COMPONENTS	Kapil Enterprises 330 EHTP, HSSI IDC, Kundli Industrial Estate Sonapat-Haryana-131028, Ph:9811009061 Email:- sales@bigboltnut.com , kapil@roll-fast.com		
REMOVE SHARP EDGES & BURRS	SHEET SIZE A4	SCALE NTS					

A

B

C

D

E

F